

## 1 ASSEMBLAGGIO STRUTTURA CHIUSA

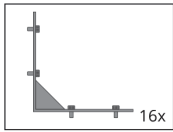

EK0285ANGOL

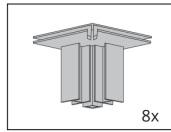

EK072044000

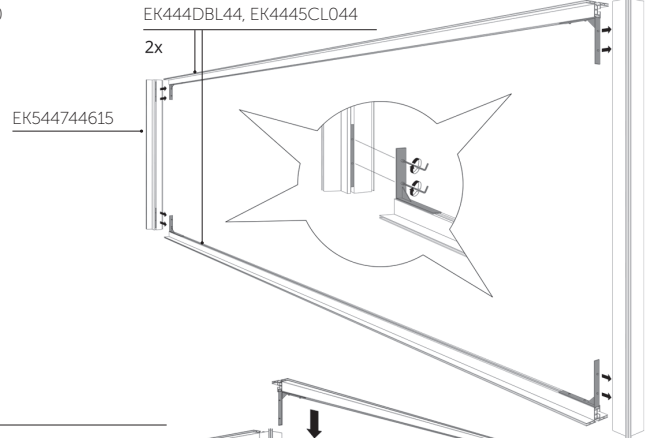

## 2 STRUTTURA DI RINFORZO CENTRALE

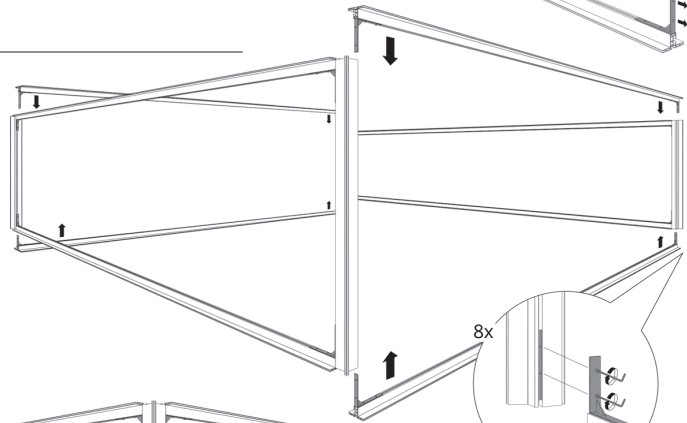
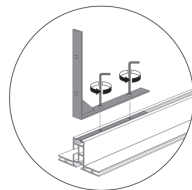

EK0220GANCI

EK4438STABL

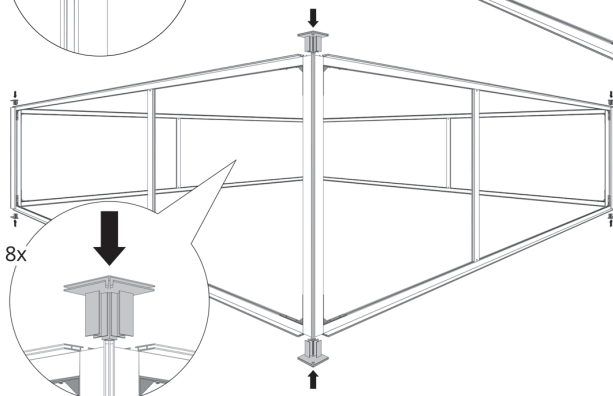
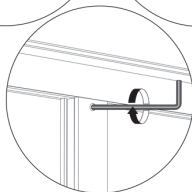
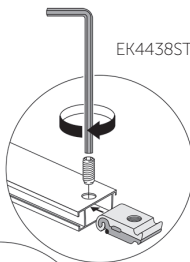
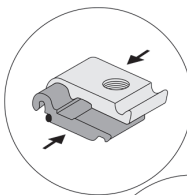

## 3 INSERIMENTO DEI TELI

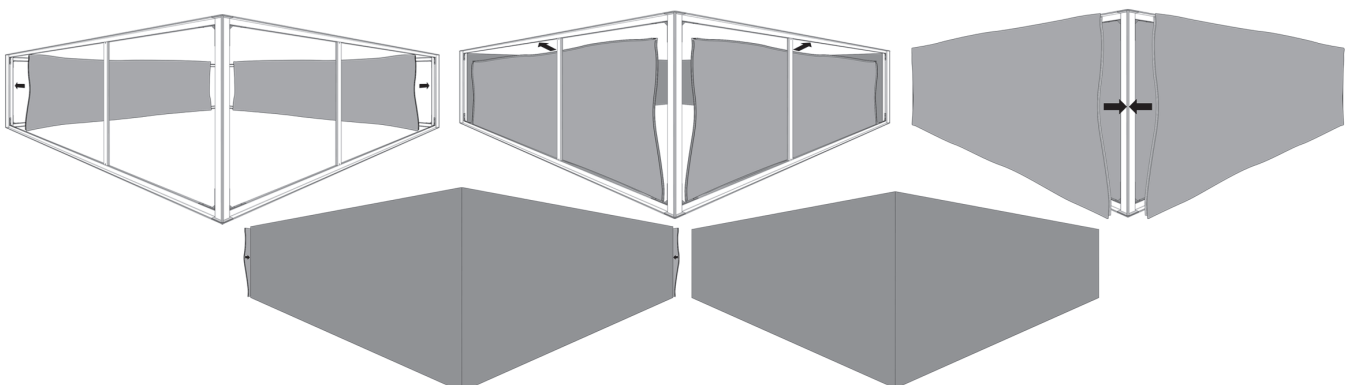
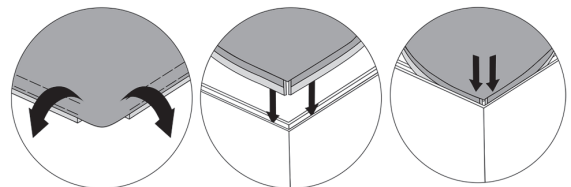

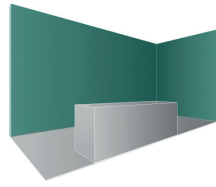

## 1 ASSEMBLAGGIO STRUTTURA A "L"

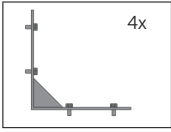

EK0285ANGOL

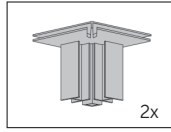

EK072044000

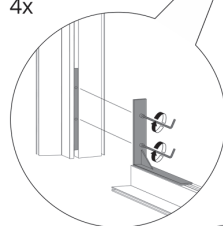
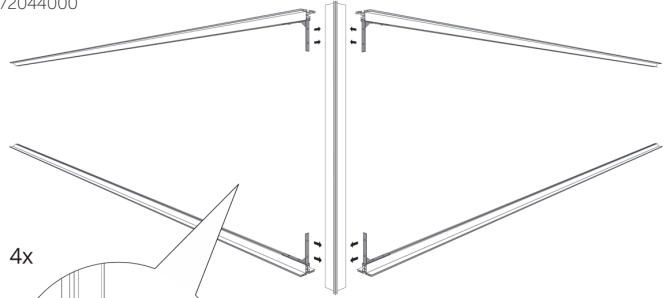
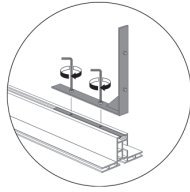

## 2 STRUTTURA DI RINFORZO CENTRALE

EK0200ANGOL

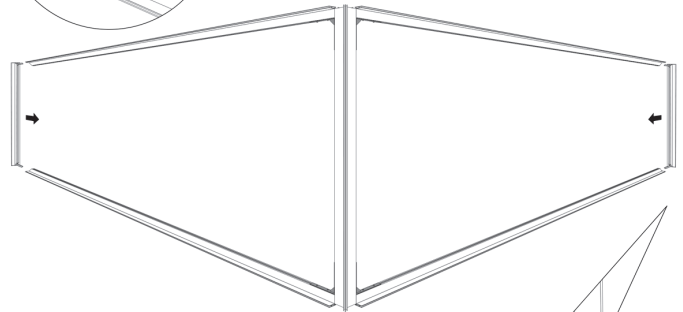
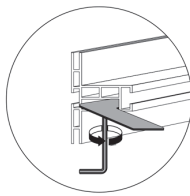
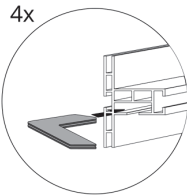
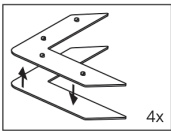

EK0220GANCI

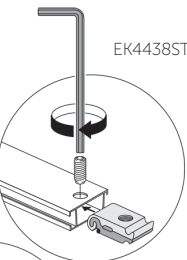
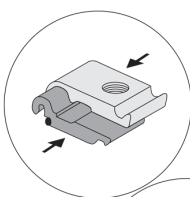

EK4438STABL

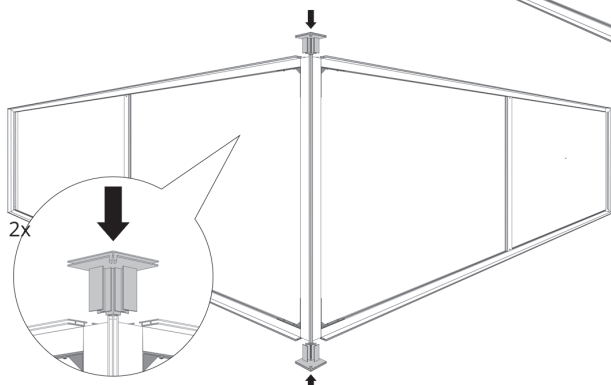
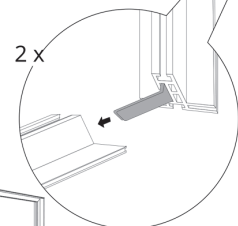
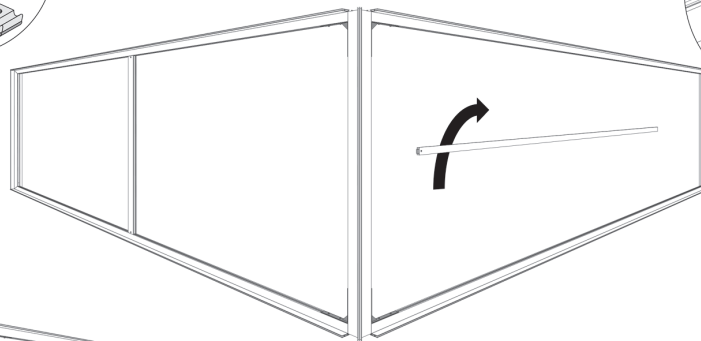
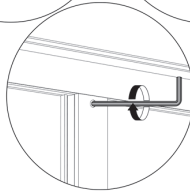

2x

## 3 INSERIMENTO DEI TELI

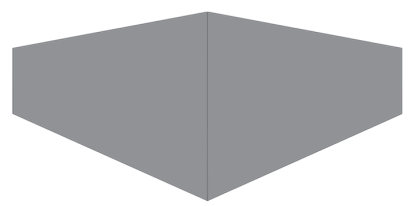
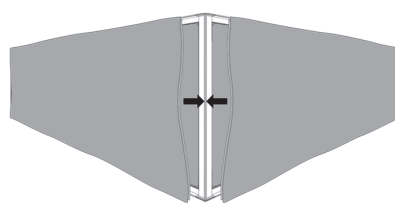
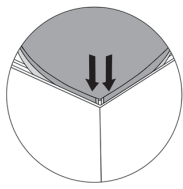
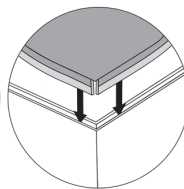
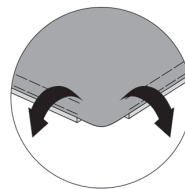

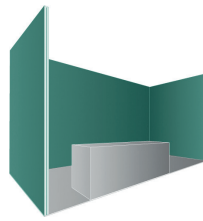

## 1 ASSEMBLAGGIO STRUTTURA A "C"

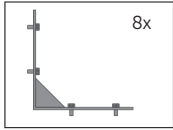

EK0285ANGOL

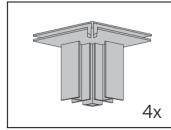

EK072044000

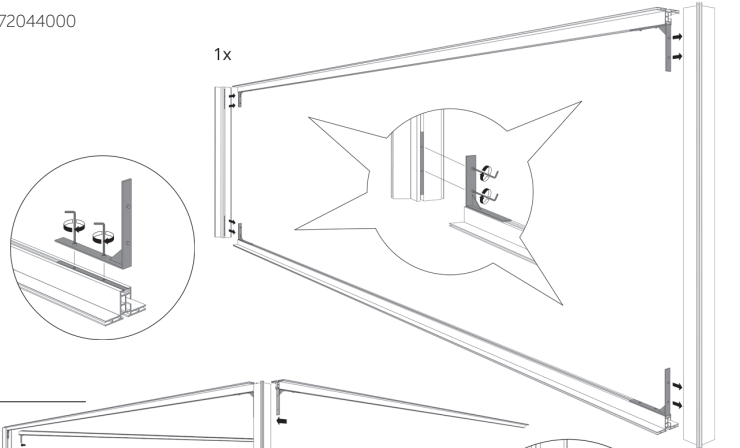

## 2 STRUTTURA DI RINFORZO CENTRALE

EK0200ANGOL

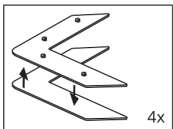

FK-0200

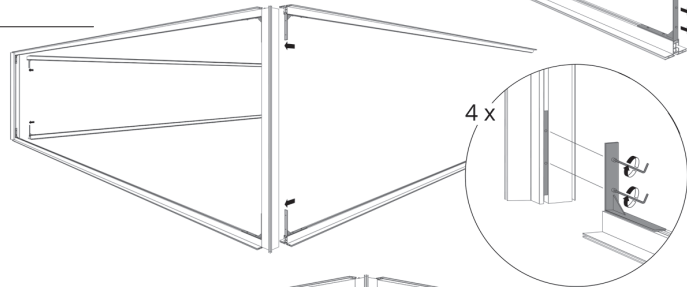
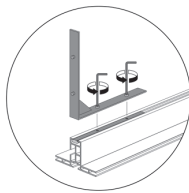
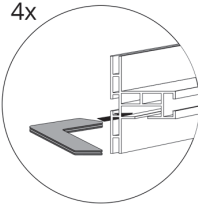

EK0220GANCI

EK4438STABL

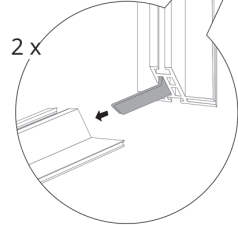
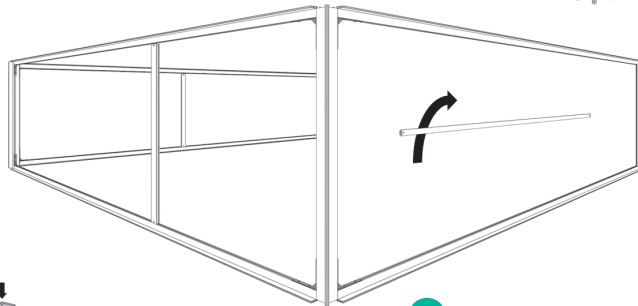
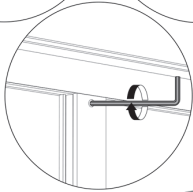
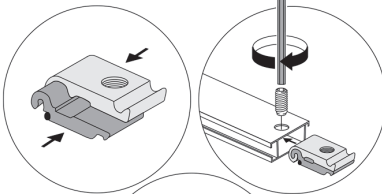

## 3 INSERIMENTO DEI TELI

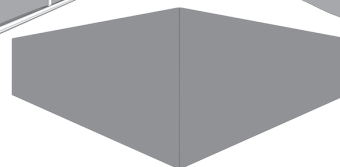
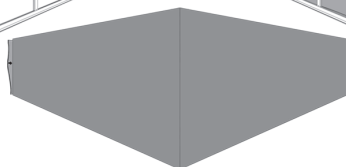
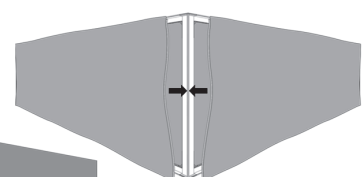
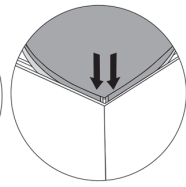
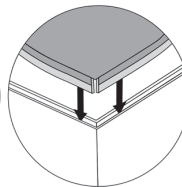
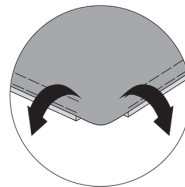
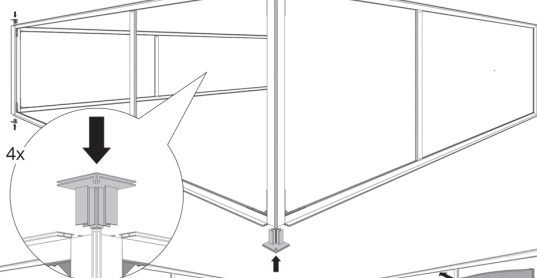

## 1 STRUTTURA A "L"



Nel caso di strutture ad "L", i due pannelli grafici interni dovranno essere ciascuno 44 mm inferiori rispetto a quelli esterni.

## 2 STRUTTURA A "C"

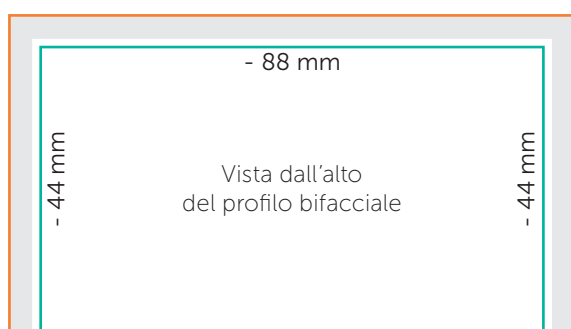

Nel caso di strutture a "C" il pannello grafico centrale sarà inferiore di 88 mm rispetto alla grafica esterna, mentre i due laterali saranno ciascuno inferiore di 44 mm rispetto a quello esterno.

## 3 STRUTTURA CHIUSA



Nel caso di una struttura completamente chiusa, ciascuno dei 4 pannelli grafici interni sarà più corto di 88 mm rispetto al corrispettivo esterno

— grafica interna profilo bifacciale  
— grafica esterna profilo bifacciale